



PROJECT		REF		REV	ITEM CODE	
LOCATION		DATE			PAGE	

SANITARY WARE SPECIFICATION SHEET

Item Descriptions	GROHE (Germany) "Plus" 3-hole basin mixer M-Size with pop-up waste set
Dimensions	L128 x W200 x H175 mm
Model	20301003
Finish	Chrome Plated
Country of origin	Germany
Manufacturer	GROHE Limited
Supplier	Acme Sanitary Ware Co. Ltd Mr. Eric Wong/ Mr. Don Yuen
Contact Tel/Fax	(852) 2388-7171 / (852) 2710-8012
E-mail	acme@acmesanitary.com.hk
Website	www.acmesanitary.com.hk

Illustration/ Drawing

Technical drawing showing dimensions and features of the GROHE Plus 3-hole basin mixer M-Size faucet. Key dimensions include: L128, W200, H175. Mounting hole positions: 50, 154, 50. Central hole: Ø34. Side hole: Ø10. Side view dimensions: 200 (+140/-60), Ø63, 35-45, G1 1/4, max.180. Max. height: 300. Max. side hole depth: 30. Angle: 0° - 6°.

Icons indicating features: GROHE StarLight, GROHE EcoJoy, GROHE QuickFix, AquaGuide.

"Plus "
3-hole basin mixer M-Size

- metal lever
- ceramic headparts 1/2", 90°
- **GROHE StarLight** chrome finish
- **GROHE EcoJoy** SpeedClean mousseur 5.7 l/min
- **GROHE AquaGuide** adjustable mousseur
- rapid installation system
- pop-up waste set 1 1/4"
- **GROHE QuickFix** installation system
- pressure-proof, flexible connection hoses between spout and side valves
- union nut 1/2" x 10.5 mm

Pop-up waste for easy operation

Elegant and easy to operate: close the pop-up waste by pulling the rod at the back of the tap and push down to open it again.

Note: [YouTube \(GROHE PLUS Faucet Collection\) https://www.youtube.com/watch?v=OcYTTcnL174](https://www.youtube.com/watch?v=OcYTTcnL174)

* All information of the above is for the reference only. No prior notice is made if any changes.



PROJECT		REF		REV	ITEM CODE	
LOCATION		DATE			PAGE	

SANITARY WARE SPECIFICATION SHEET

GROHE PLUS

ACCURACY THAT GOES BEYOND DESIGN

Imagine a bathroom that offers not just sleek, cutting-edge, bold design design, but also confidence and control. Where you can tell water temperature at a glance and switch water flow with just a swipe of your hand. A room where nothing is left to chance, where form delivers function in a sleek, tactile package. With the new GROHE Plus you can make it a reality.

This innovative range puts control and convenience in your hands, delivering accurate temperature information at a glance. The GROHE Plus range includes some faucets with a temperature display, so you know the water will always be just the right temperature. GROHE Plus also offers a new level of ergonomic comfort and practical function too, presented in a silhouette of architectural strength and elegance, with surfaces so sleek they invite interaction.



GROHE EcoJoy with water-saving function for reduced consumption

GROHE EcoJoy reduces water consumption by up to 50% without compromising on performance. Whenever you turn on your tap, you will enjoy a full jet of water while saving money nonetheless.



SpeedClean: easy cleaning thanks to silicone nozzle

Indeed, the name says it all: with the SpeedClean technology, you'll have limescale removed from the spout in the blink of an eye thanks to a nozzle made of silicone. A quick wipe with your fingers is all it takes to remove any limescale deposits, saving you a lot of time and effort!



GROHE QuickFix Plus quick and easy installation in a few simple steps

Save time on the installation of your tap with GROHE QuickFix Plus. Consisting of fewer parts, our new system makes the installation process quicker and easier than ever.

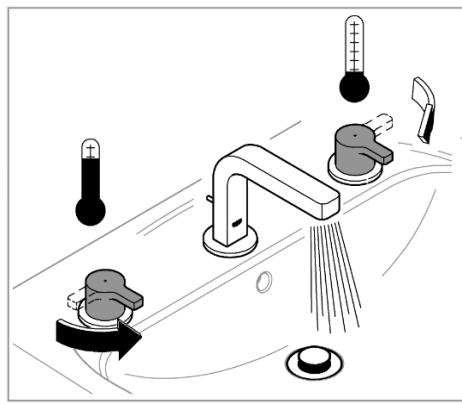
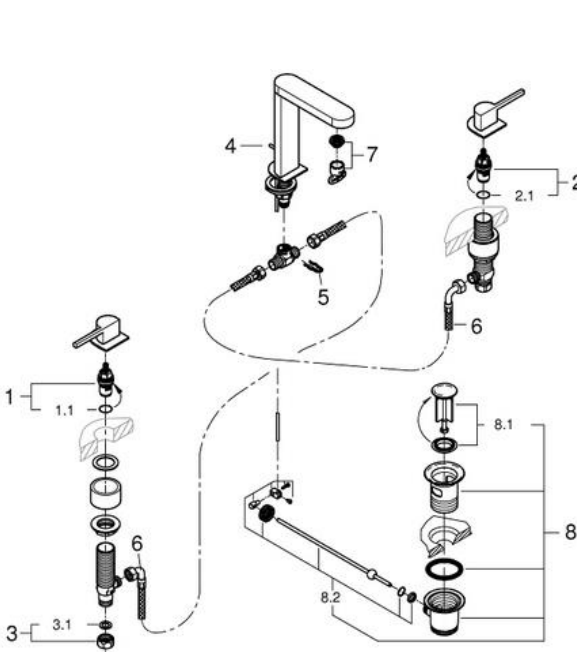

Pos.-nr.	Prod. Description	Order-nr.
1	Ceramic headpart, 1/2"	45882000
1.1	O-ring ø18.2 x ø1.7	0392400M
2	Ceramic headpart, 1/2"	45883000
2.1	O-ring ø18.2 x ø1.7	0392400M
3	Coupling nut 1/2" x 10.5 mm	1290100M
3.1	Fibre seal dia. 12x2 mm	0138900M
4	Pop-up rod	65196000
5	Fixing clamp	6554100M
6	Flexible connection hose	45704000
7	Mousseur	48493000
8	Pop-up waste set 1 1/4"	28910000
8.1	Plug for pop-up waste set	07182000
8.2	Eccentric rod	07052000
9	Coupling nut 1/2" x 14.5 mm	1290200M*
10	Eccentric rod	07341000*

* Optional accessories

		Ø10.5		8.2	180mm
		Ø14.3		10	350mm

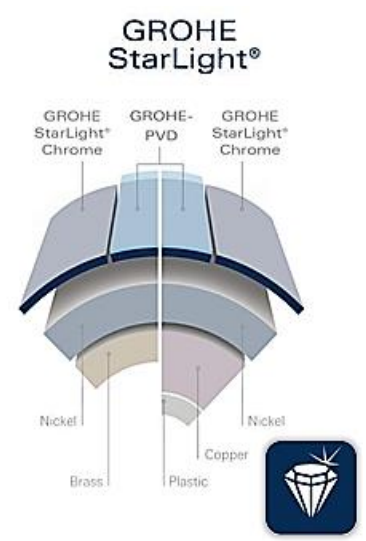

GROHE surface hardness
 x3
 Chrome PVD

GROHE scratch resistance
 x10
 Chrome PVD

Note:

* All information of the above is for the reference only. No prior notice is made if any changes.



水務署
Water Supplies Department

總部 Headquarters

香港灣仔告士打道七號入境事務大樓 48 樓

48/F Immigration Tower, 7 Gloucester Road, Wan Chai, Hong Kong

本署轄
Our ref.
來函檔
Your ref.



21/2022 T/J(1377/2022)

電話

Tel.

傳真

Fax.

: 2824 0578

9 March 2023



**Approval of "GROHE" Basin Mixer
(General Acceptance No. C20230135)**

Your letters ref. WRC/2379, C-WSD/0996 and C-WSD/0999 dated 12 December 2022, 16 January 2023 and 16 February 2023 respectively refer.

Having considered the test reports ref. J24537Ar4 issued on 4 January 2023 and ref. J24825r2 issued on 5 March 2021 by Nutek Systems (HK) Ltd., this Authority accepts that the fitting described below complies with, and its use when correctly installed does not contravene, the Waterworks Ordinance and Regulations.

Name of Manufacturer: Grohe AG

Country of Origin: Germany

Brand: Grohe

Details of Fitting: 1/2" 3-holes basin mixer with 2 nos. of flexible hoses

Model: 20301XX3
(where "XX" denotes the code of colour)

Body Markings: 

Expiry Date: 8 August 2024



This Authority hereby permits the use of the above fitting in fresh water plumbing systems subject to full adherence to Waterworks installation requirements. In particular, you are required to draw your customers' attention to the following requirement-

“The cold water supply to the fitting shall be drawn from the same source that supplies the hot water apparatus so as to provide a balanced pressure and to obviate the risk of scalding in the event of a restriction or failure in the water supply.”

A condition of this acceptance is that the fitting to be installed shall be replicas of the sample as certified by the testing agent mentioned above and without modifications. This acceptance may be withdrawn at any time if the standard of the fitting installed fails to meet that of the approved sample or if the fitting is found to be unsuitable for use in fresh water plumbing systems.

This acceptance is only applicable to the main body of the fitting, unless otherwise specified.

For the use of the fitting in any project, the General Acceptance Number of this letter must be quoted as a means of identification of acceptance of the fitting by this Authority.

Should you have any enquiries, please contact our Engineer Ms Winnie LO at tel. no. 3583 4086.

Yours faithfully,



(YAU Hau Yin)

for Director of Water Supplies

Encl.

c.c. WSD 3321/1/82] - without catalogue
 ME/MC] - with soft copy only